



SEAT LCR TCR V3 DSG Tightening Torque Manual

TIGHTENING TORQUE INDEX



Notes	3
Engine Fly Wheel And Clutch	4
Engine & Gearbox Supports	5
Turbocharger	6
Alternator	7
Fuel System	8
Intermediate Axle	10
Drive Shaft	11
Front Upright And Hub	12
Front Brake	13
Front Subframe	14
Front Wishbone	15
Front Shock Absorber	16
Steering Rack & Column	17
Rear Upright	18
Rear Shock Absorber	19
Rear Subframe	20
Pedal Box	21
Front & Rear End	22
Bucket Seat	23
Ballast Fixation	24
DSG Gearbox	25



TIGHTENING TORQUE NOTES



In this manual you will find the tightening torques of the vehicle with exploded views. Attached to the different parts there is a reference with some information. There is an example here below to understand how to read it:

TO BODY SHELL	←	It Explains Where The Part Is Assembled On.
VN0001161339	←	Catalogue Reference
BOLT	←	Name
M10x30 60 Nm	←	Size & Torque
LOCTITE 243 Blue	←	Additional Useful Information

Besides the reference, the bolts, nuts, spacers and bushes may be marked with a color spot next to them. The ones with the same color spot have the same information and thus the same tightening torque. If no color spot is found means that the part is a single unit. The colors are common in one single page and are not related between different pages.

Spot colors: ● ● ● ● ● ●

TIGHTENING TORQUE

ENGINE FLY WHEEL AND CLUTCH

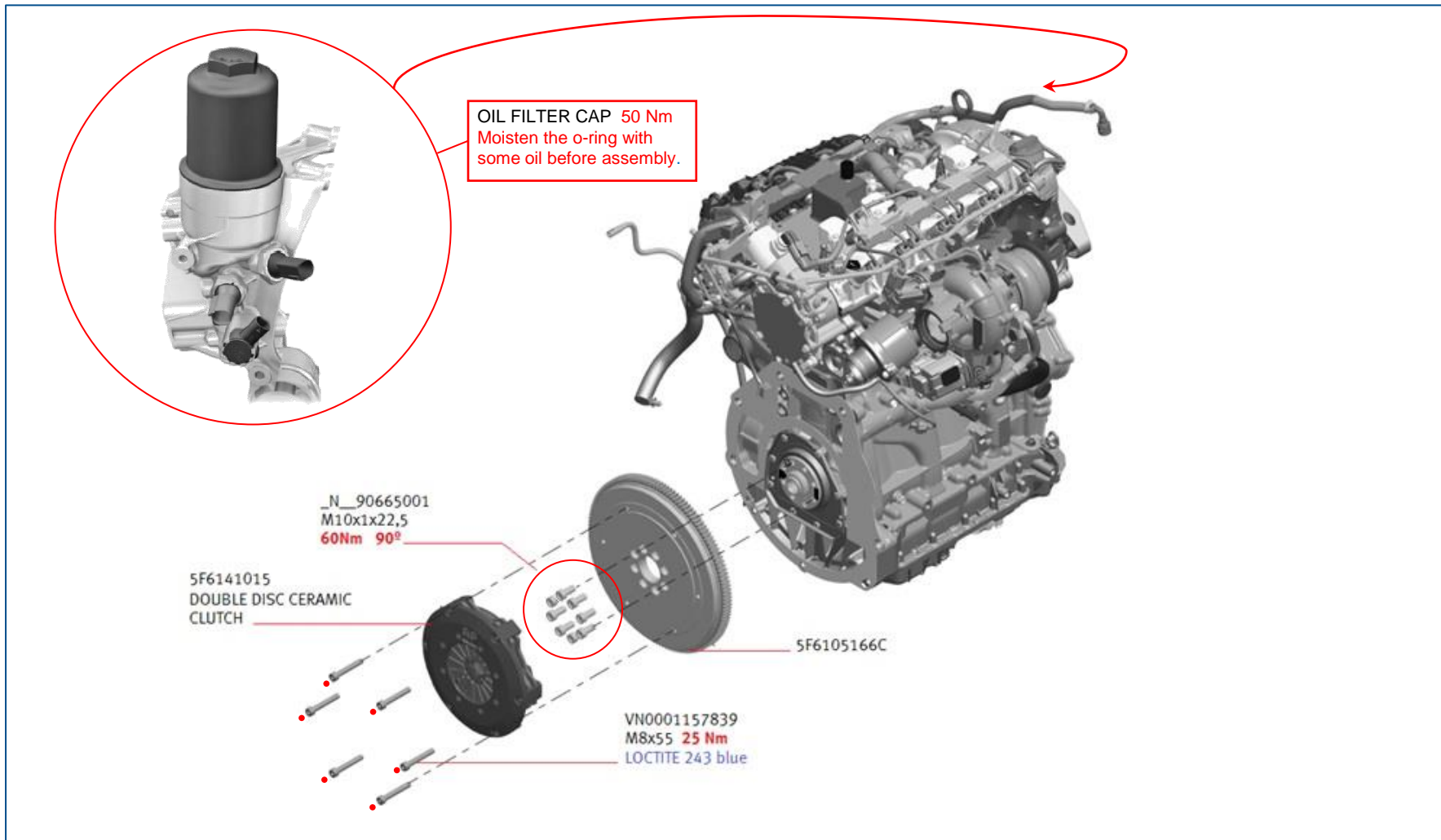

TIGHTENING TORQUE

ENGINE & GEARBOX SUPPORTS

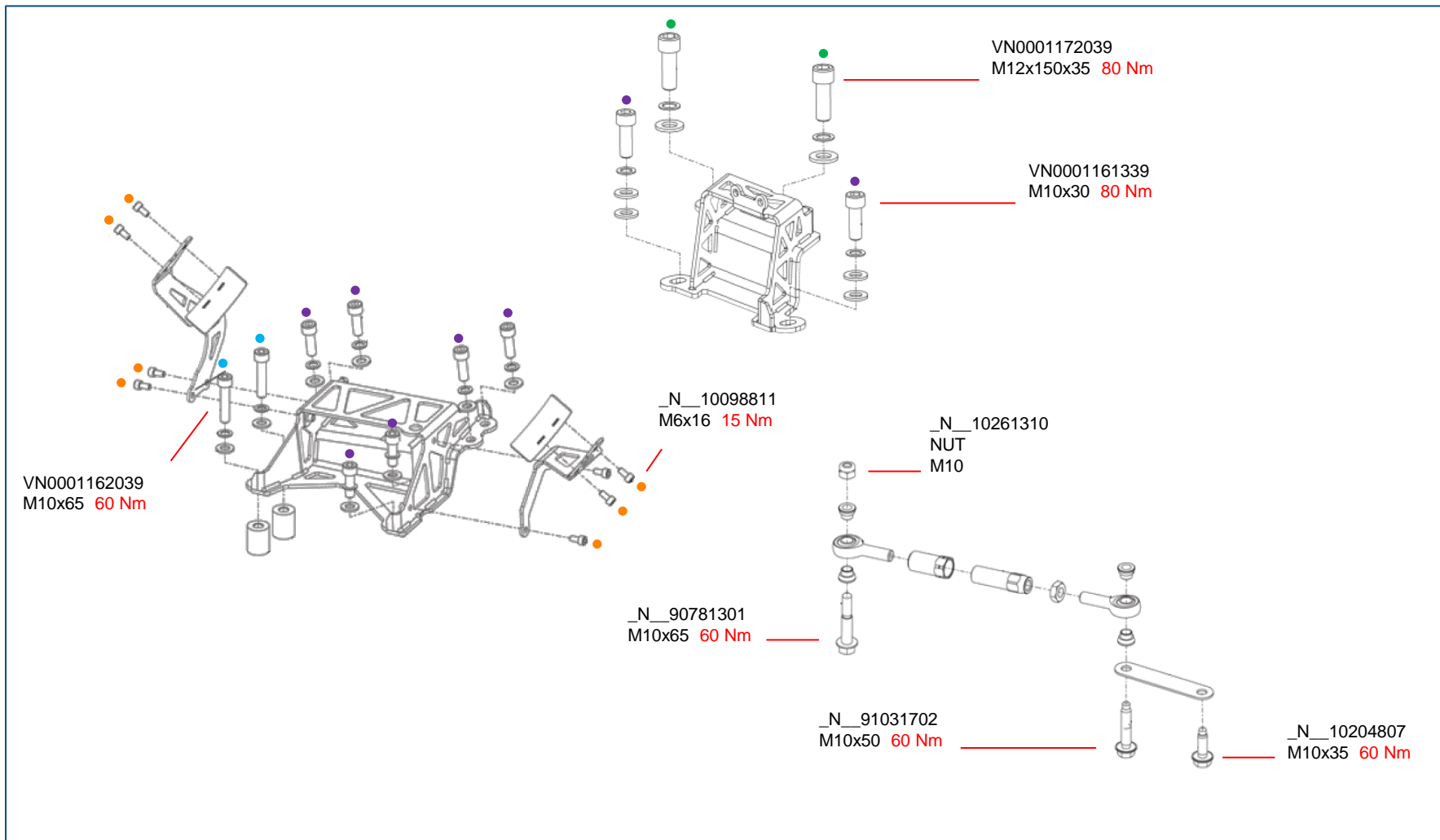

TIGHTENING TORQUE TURBOCHARGER

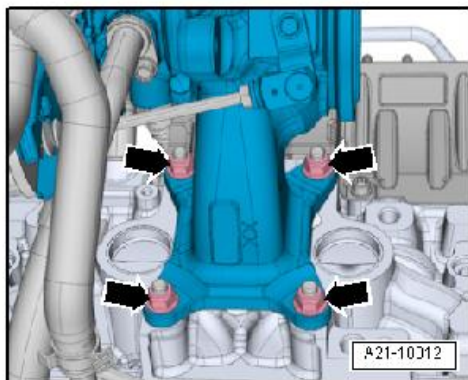

TO REPLACE THE TURBOCHARGER

USE ALWAYS:

NEW EXHAUST GASKET
NEW NUTS
NEW EXHAUST CLAMP

TAKE OUT SENSE

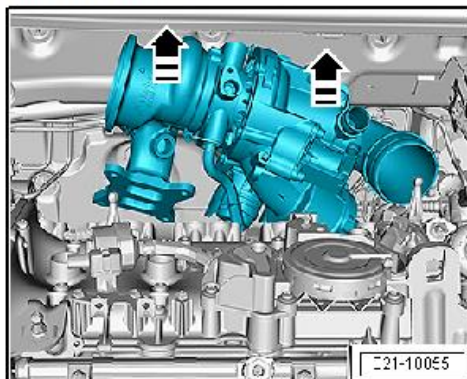

_N_91130801
NUT M8 **25 Nm**
Cu grease

_06L253039
GASKET

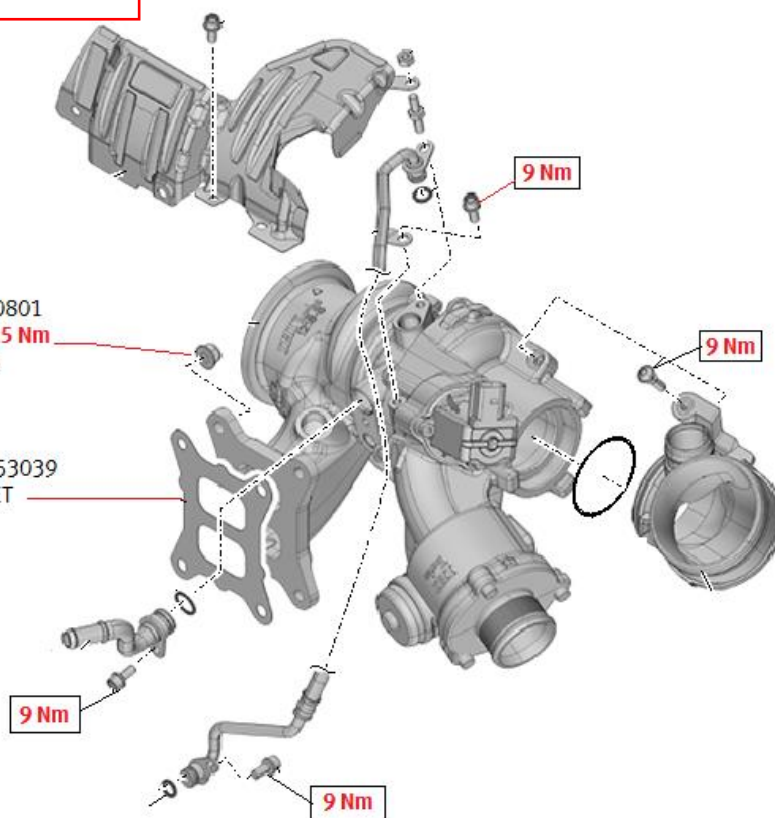

TIGHTENING TORQUE ALTERNATOR

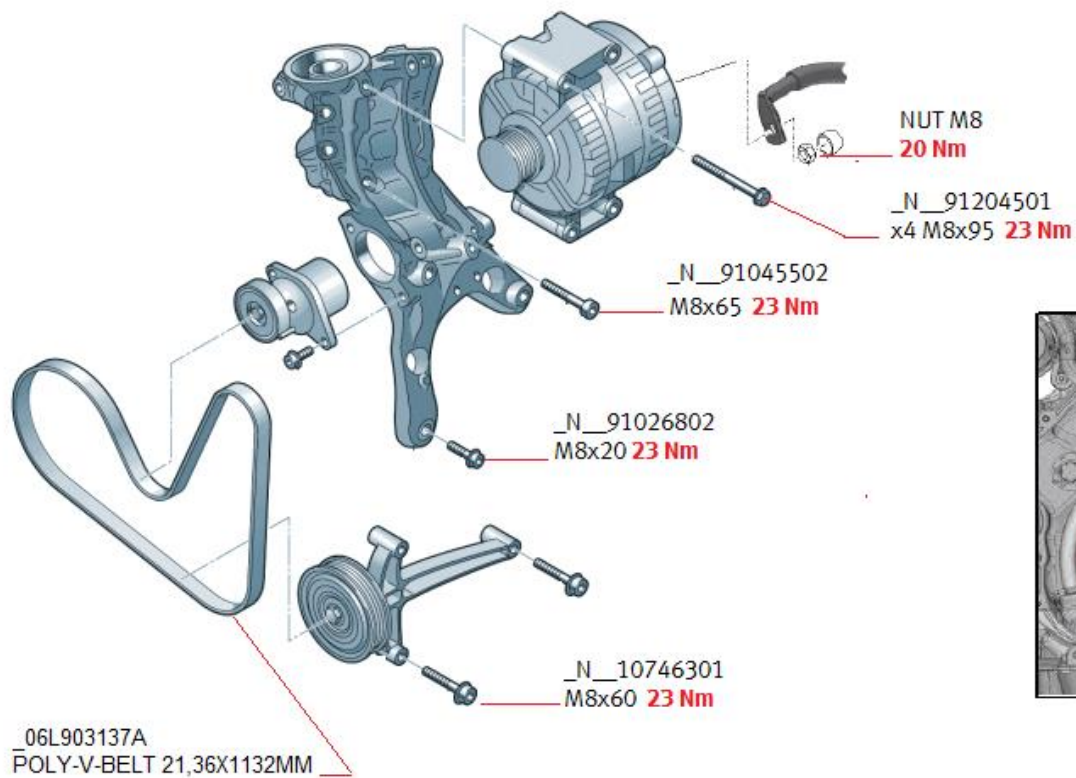

- 1 Vibration damper
140 Nm
- 2 Tensioner for V belt
- 3 Poly-V bell puley to alternator
M10 **65 Nm**

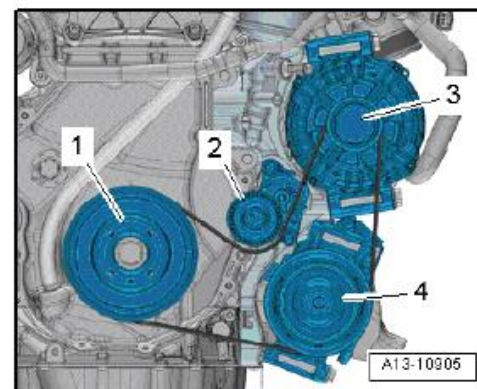

TIGHTENING TORQUE FUEL SYSTEM

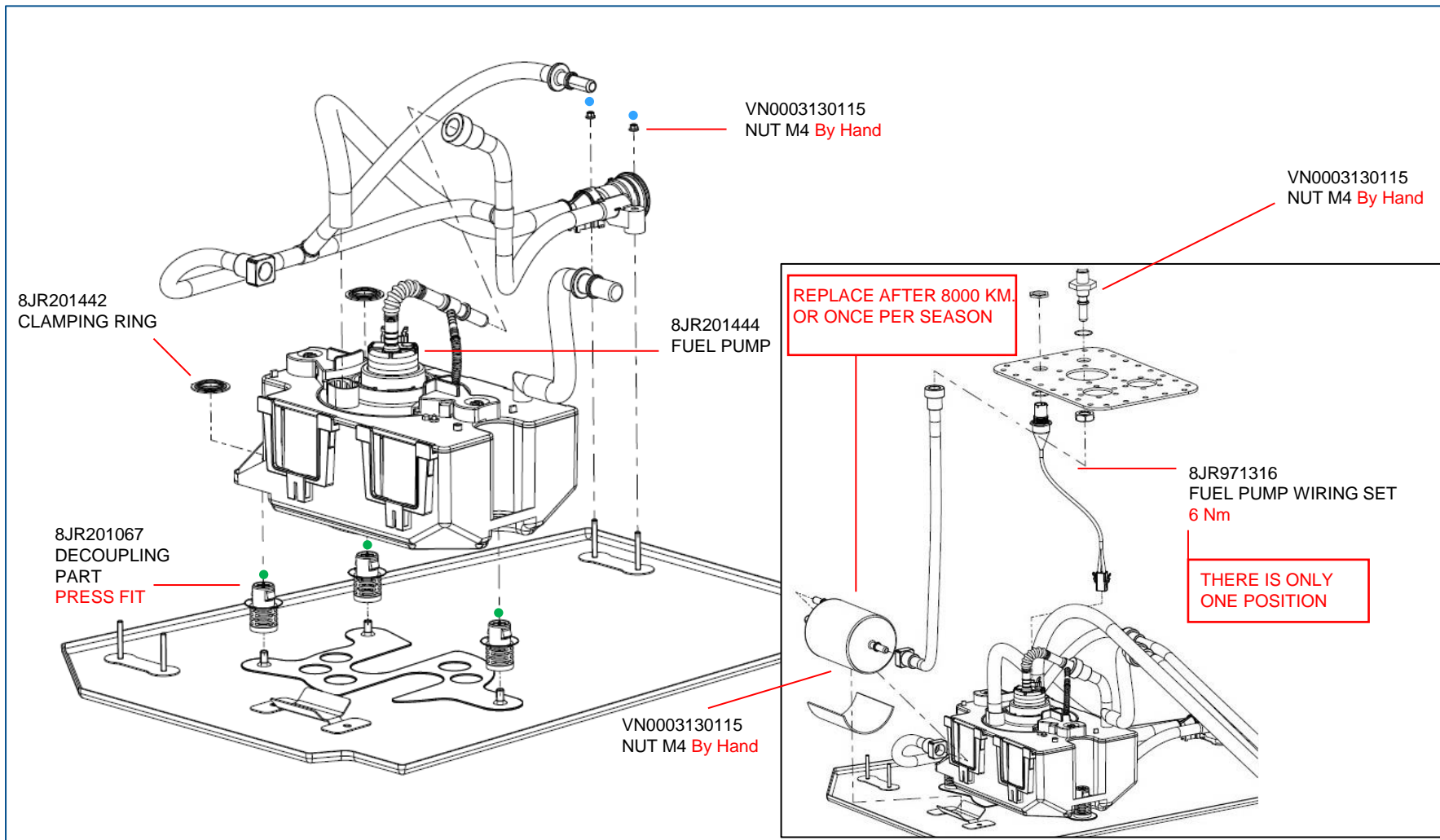

TIGHTENING TORQUE

FUEL SYSTEM

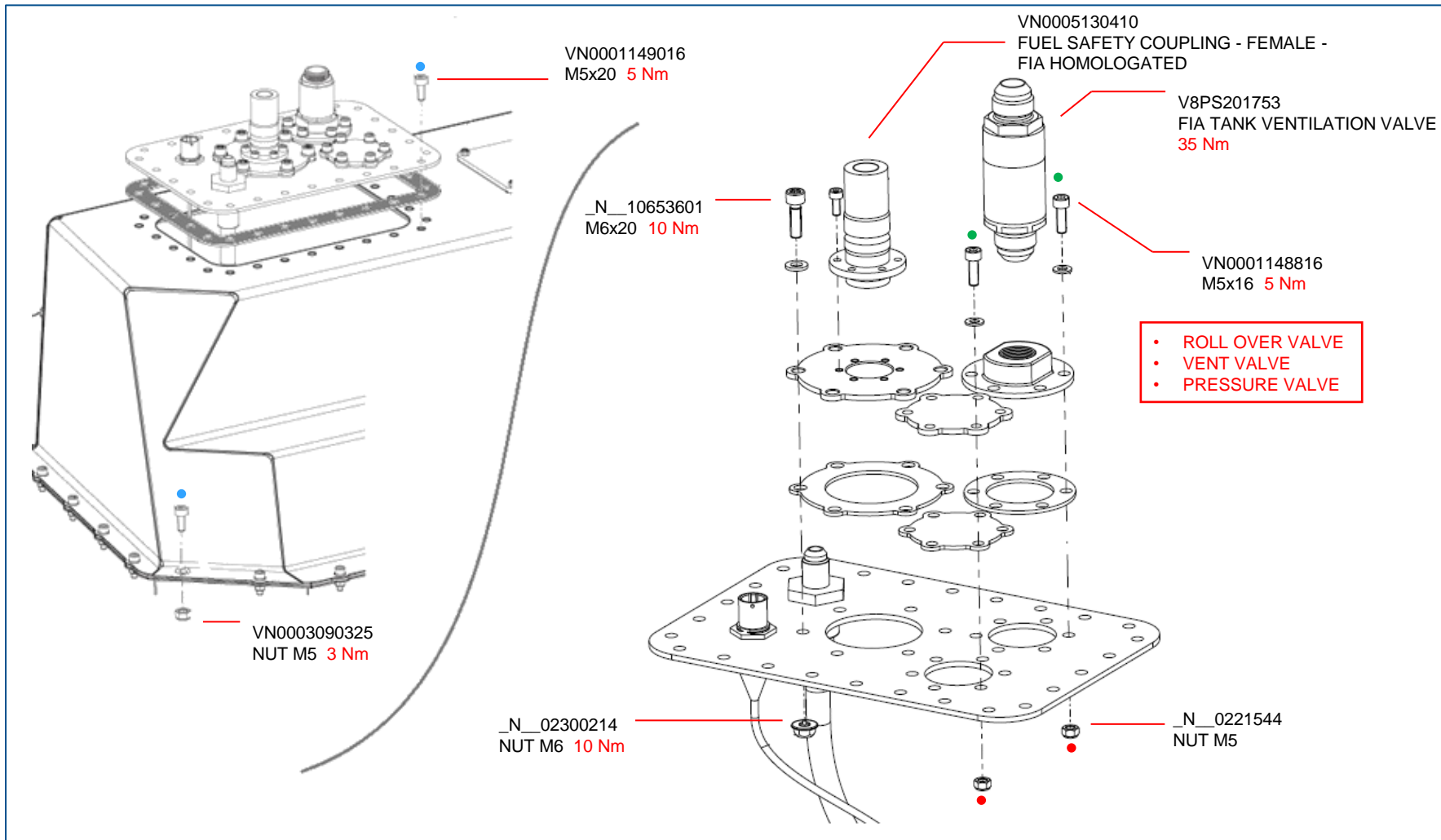

TIGHTENING TORQUE INTERMEDIATE AXLE

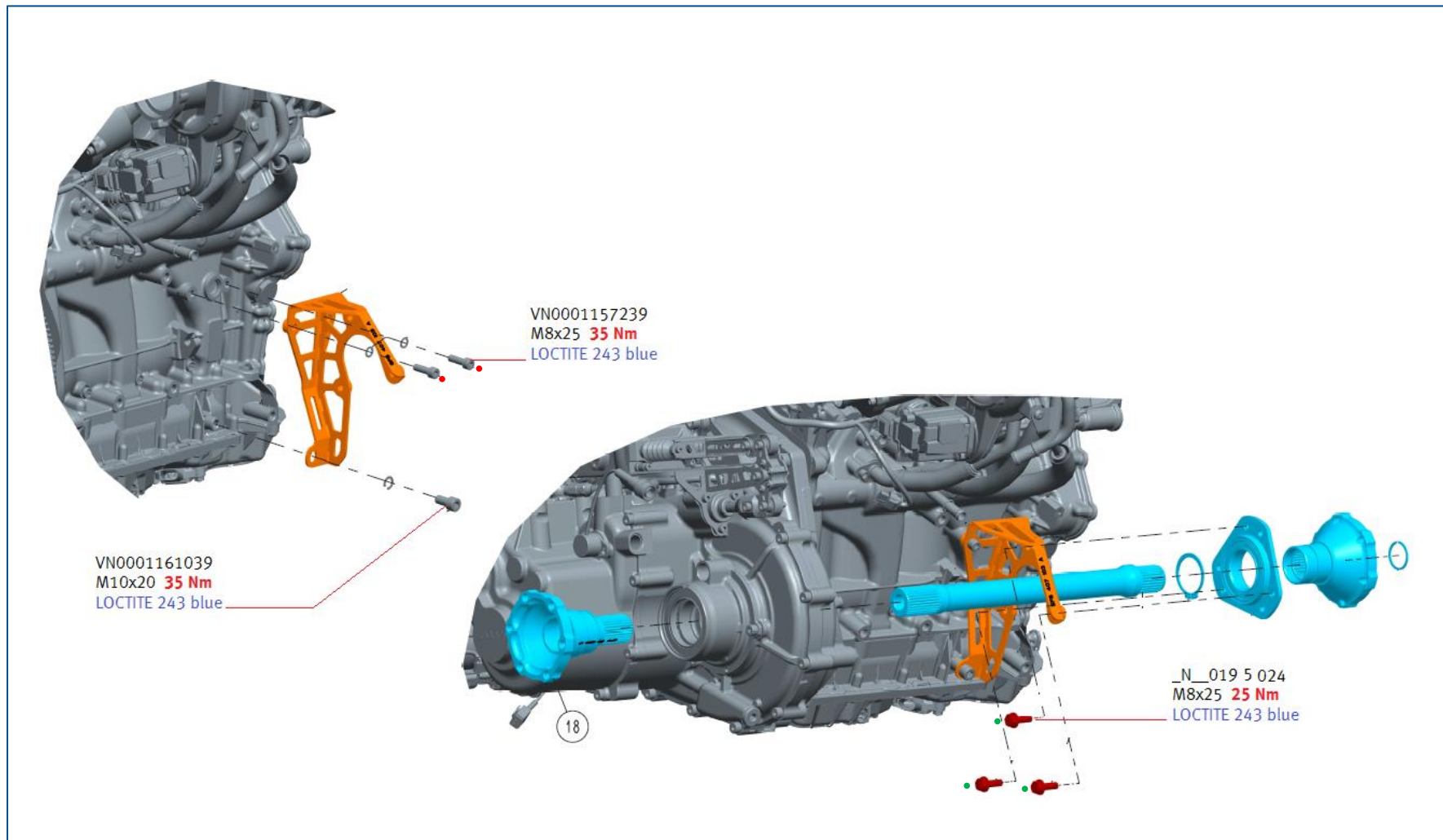

TIGHTENING TORQUE DRIVE SHAFT

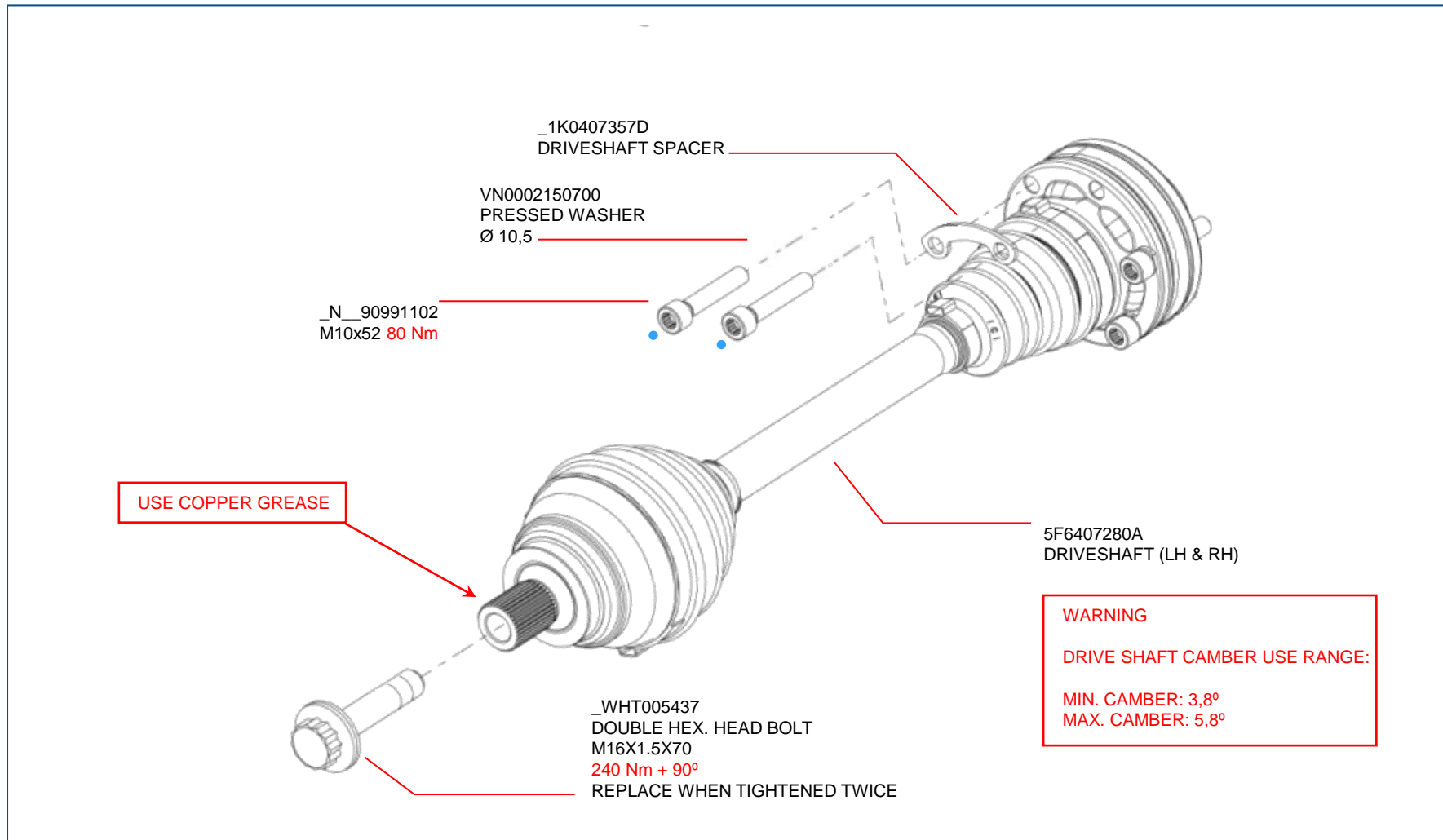

TIGHTENING TORQUE FRONT UPRIGHT AND HUB

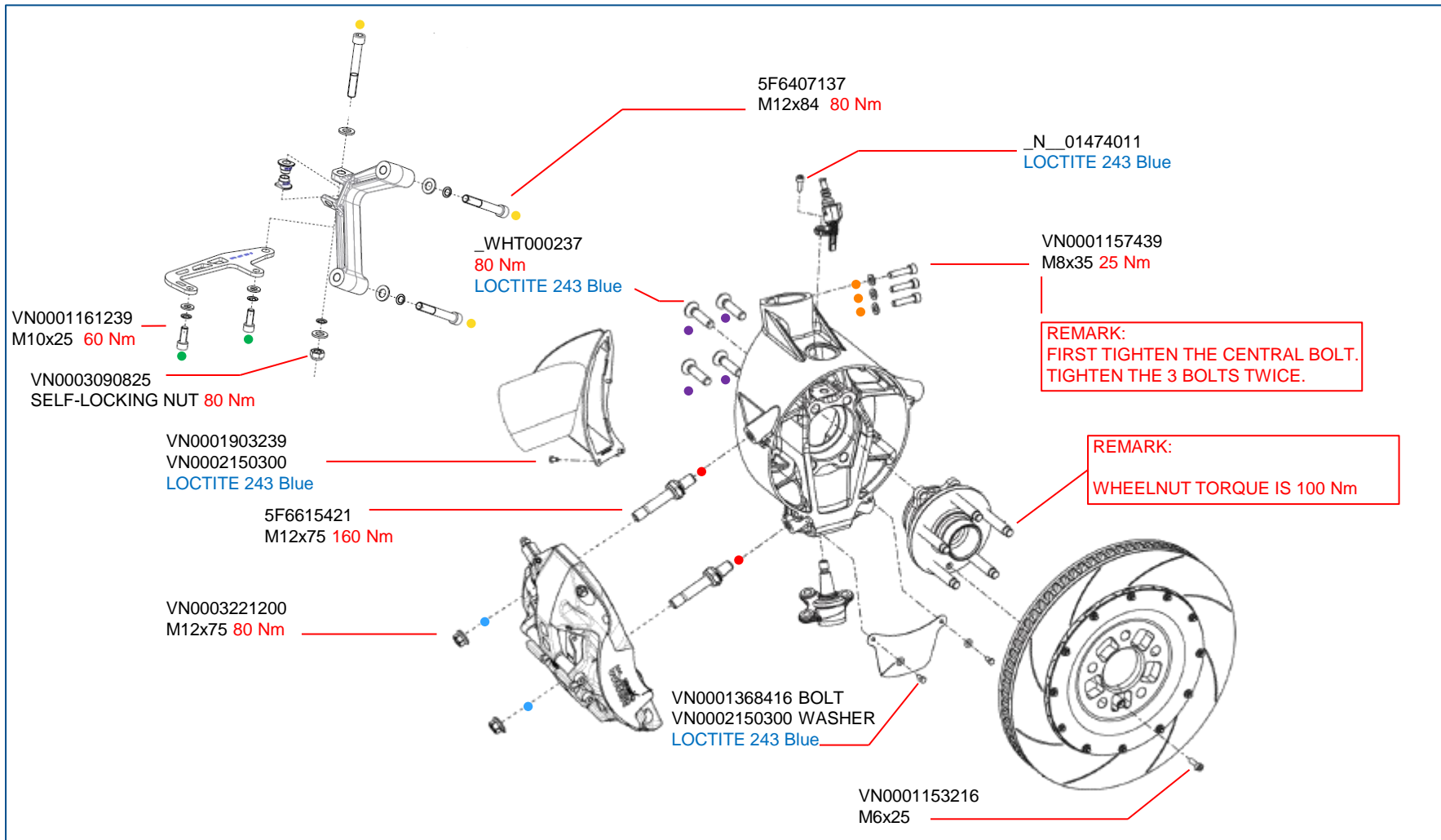

TIGHTENING TORQUE FRONT BRAKE

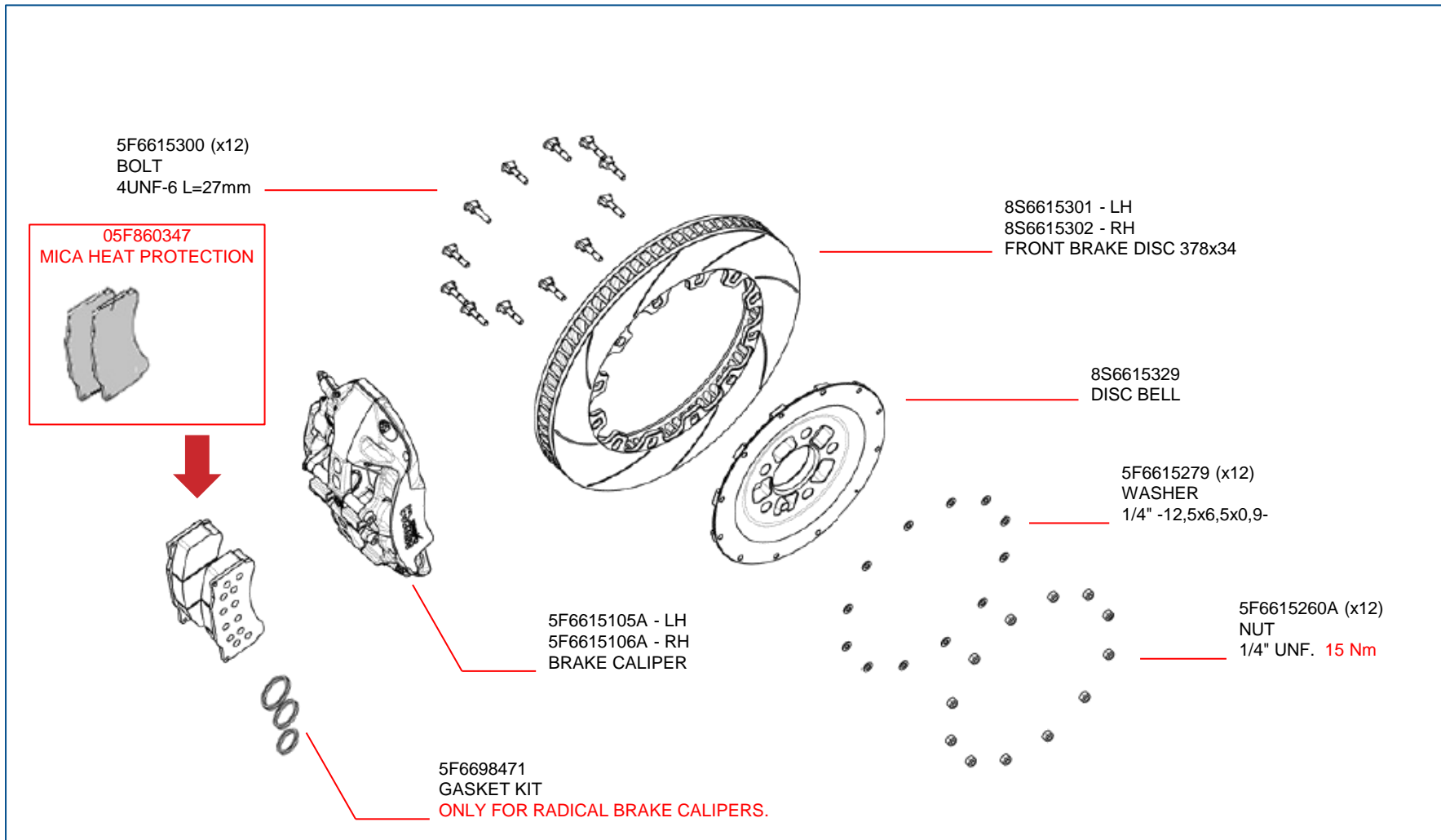

TIGHTENING TORQUE FRONT SUBFRAME

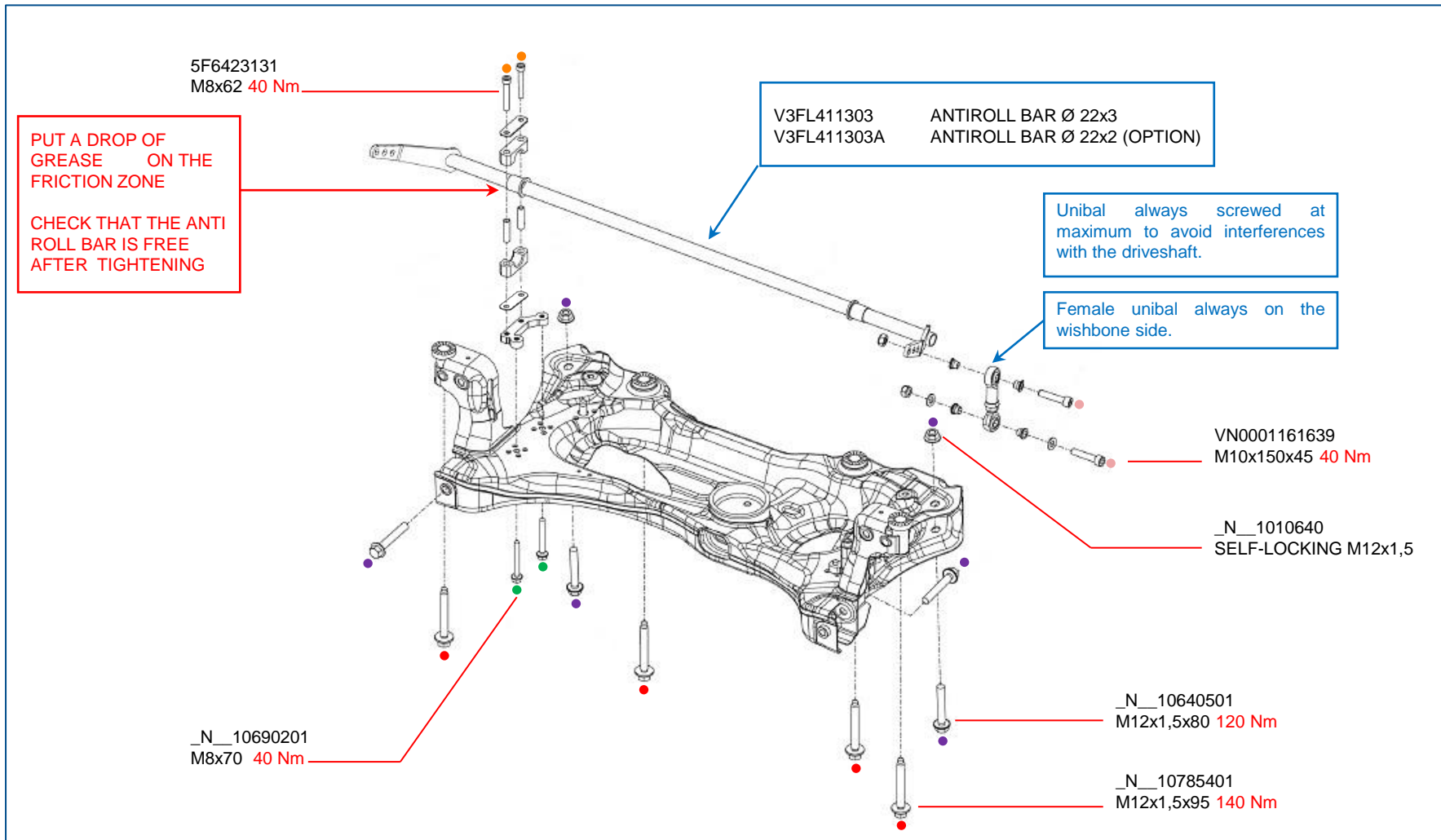

TIGHTENING TORQUE FRONT WISHBONE

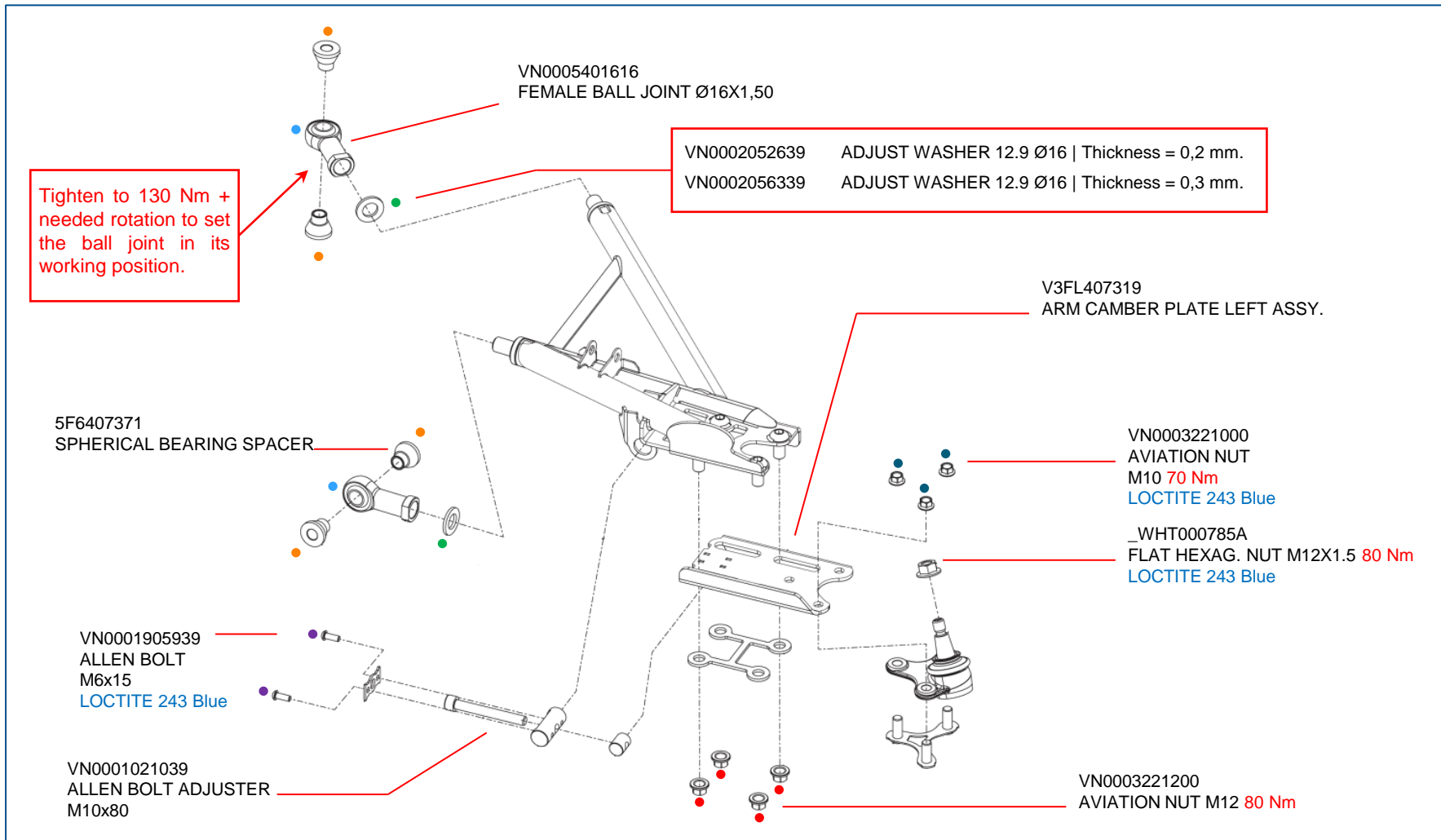

TIGHTENING TORQUE FRONT SHOCK ABSORBER

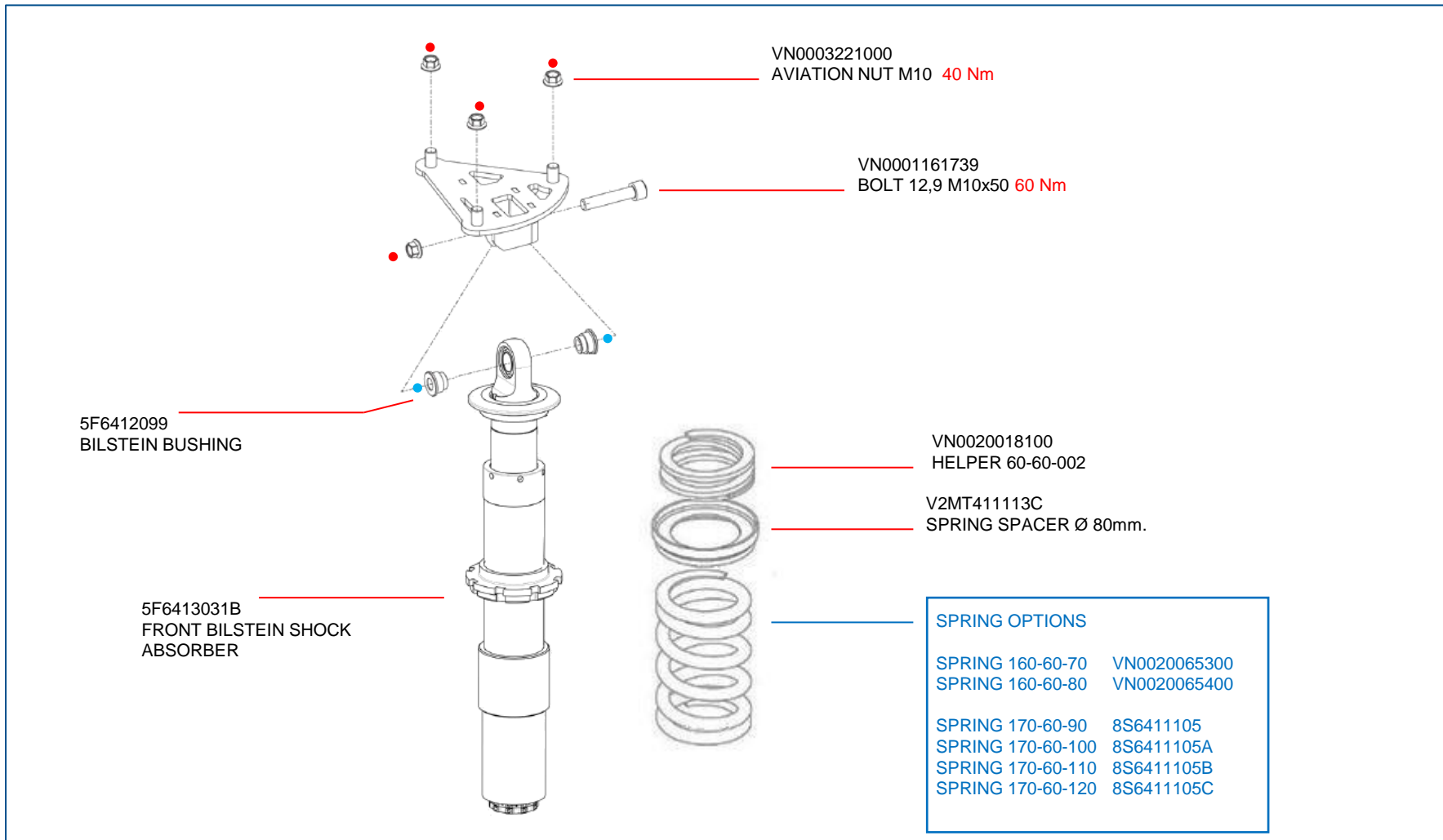

TIGHTENING TORQUE STEERING RACK & COLUMN

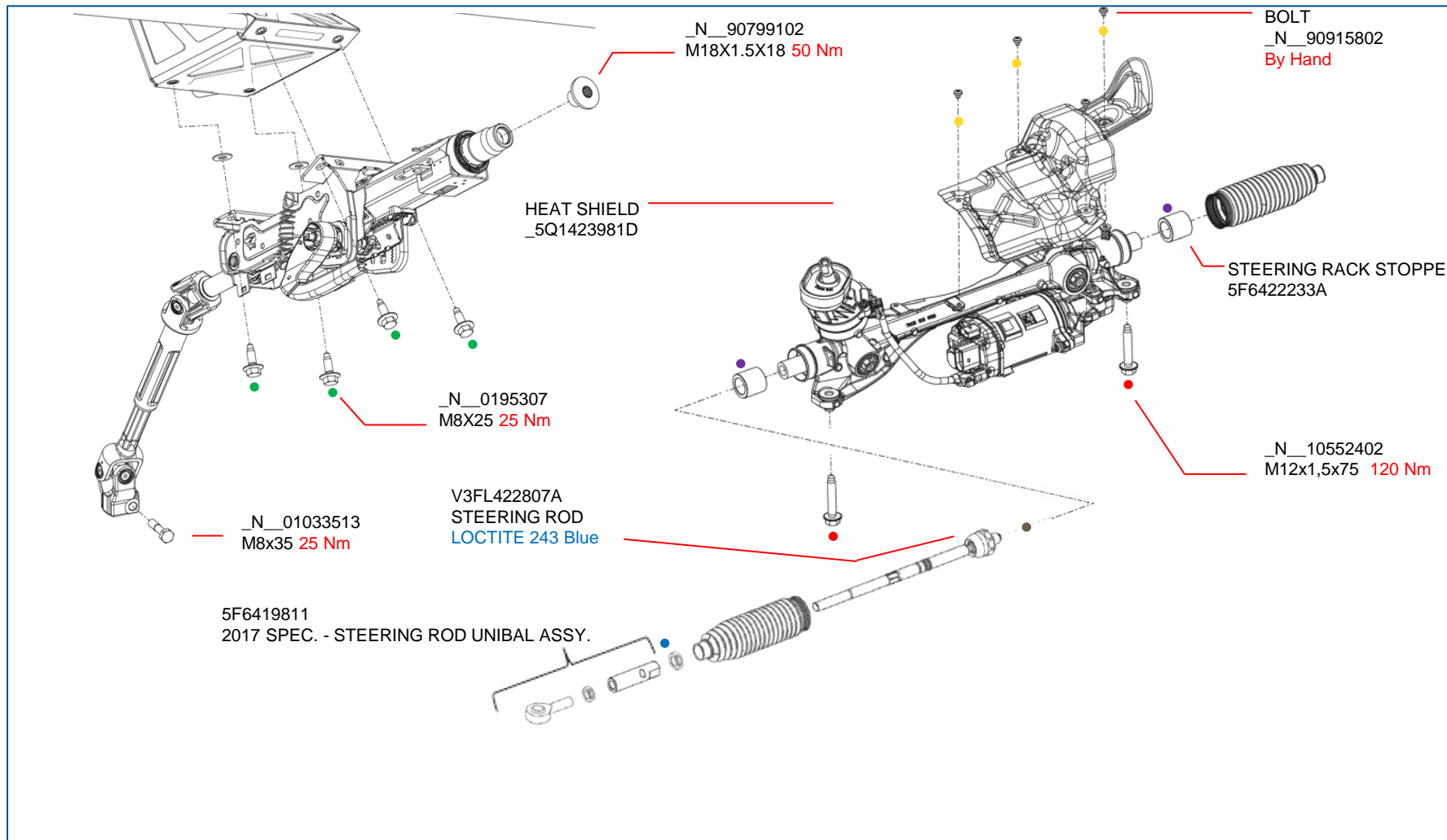

TIGHTENING TORQUE REAR UPRIGHT

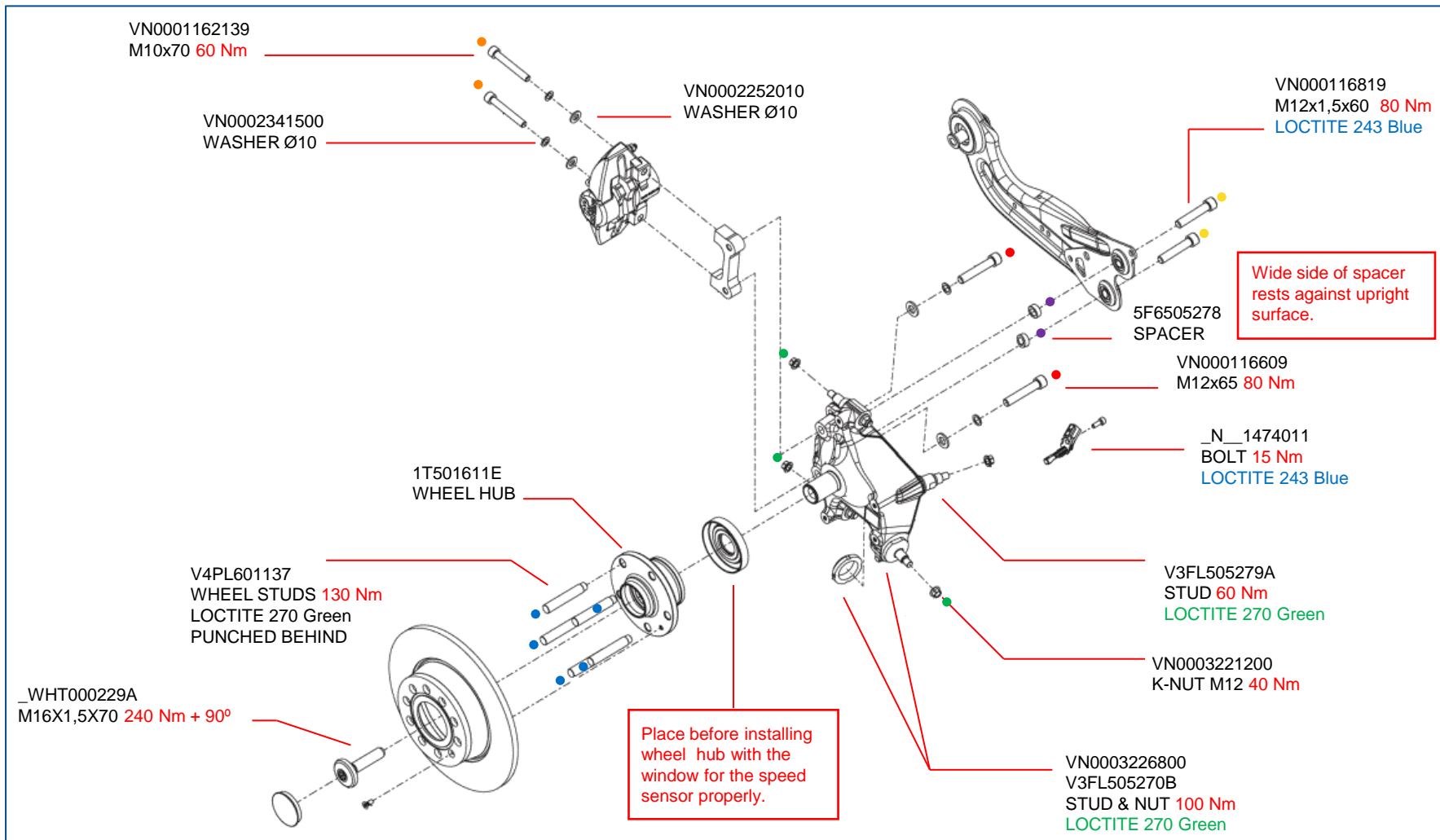

TIGHTENING TORQUE REAR SHOCK ABSORBER

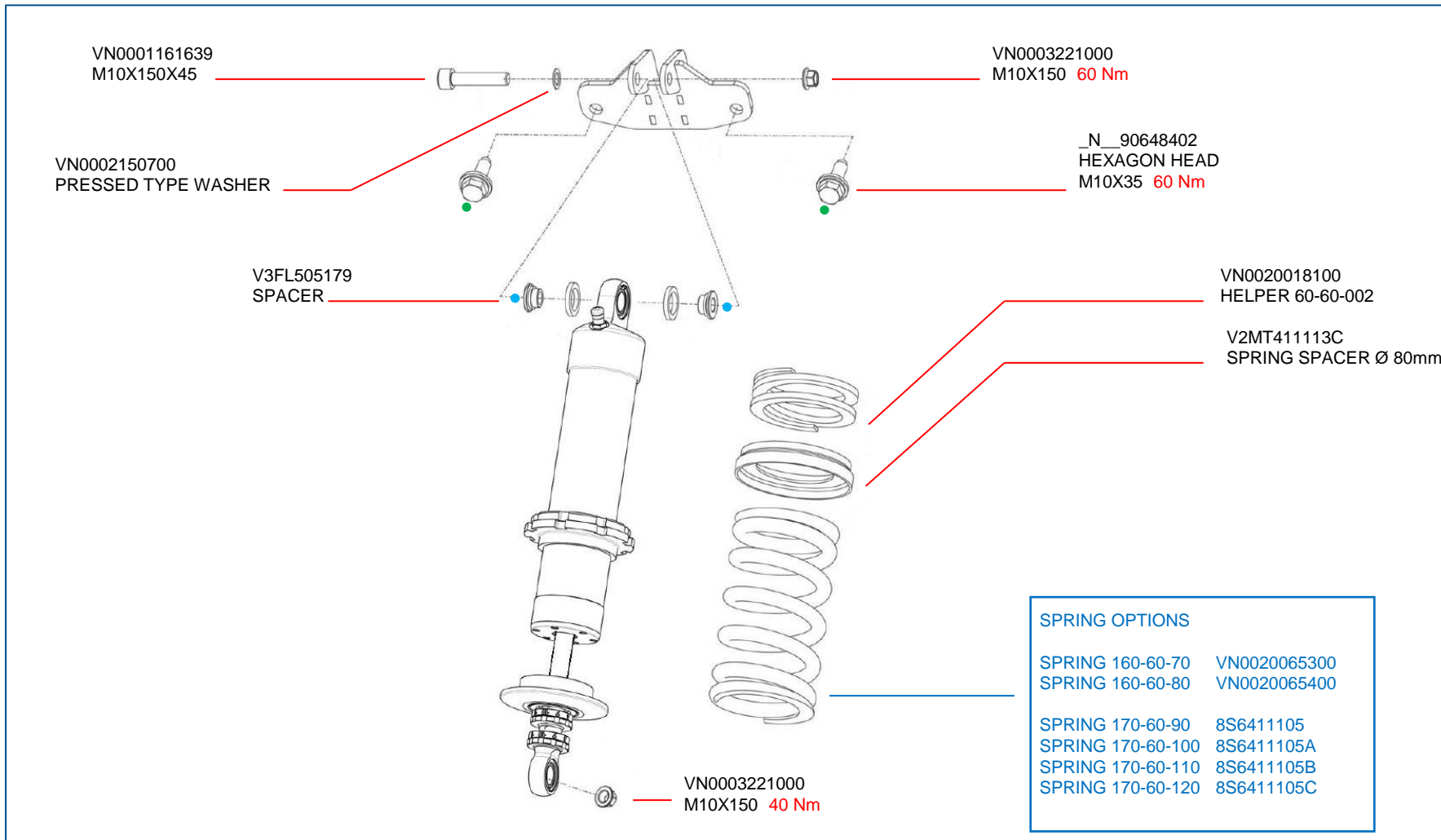

TIGHTENING TORQUE REAR SUBFRAME

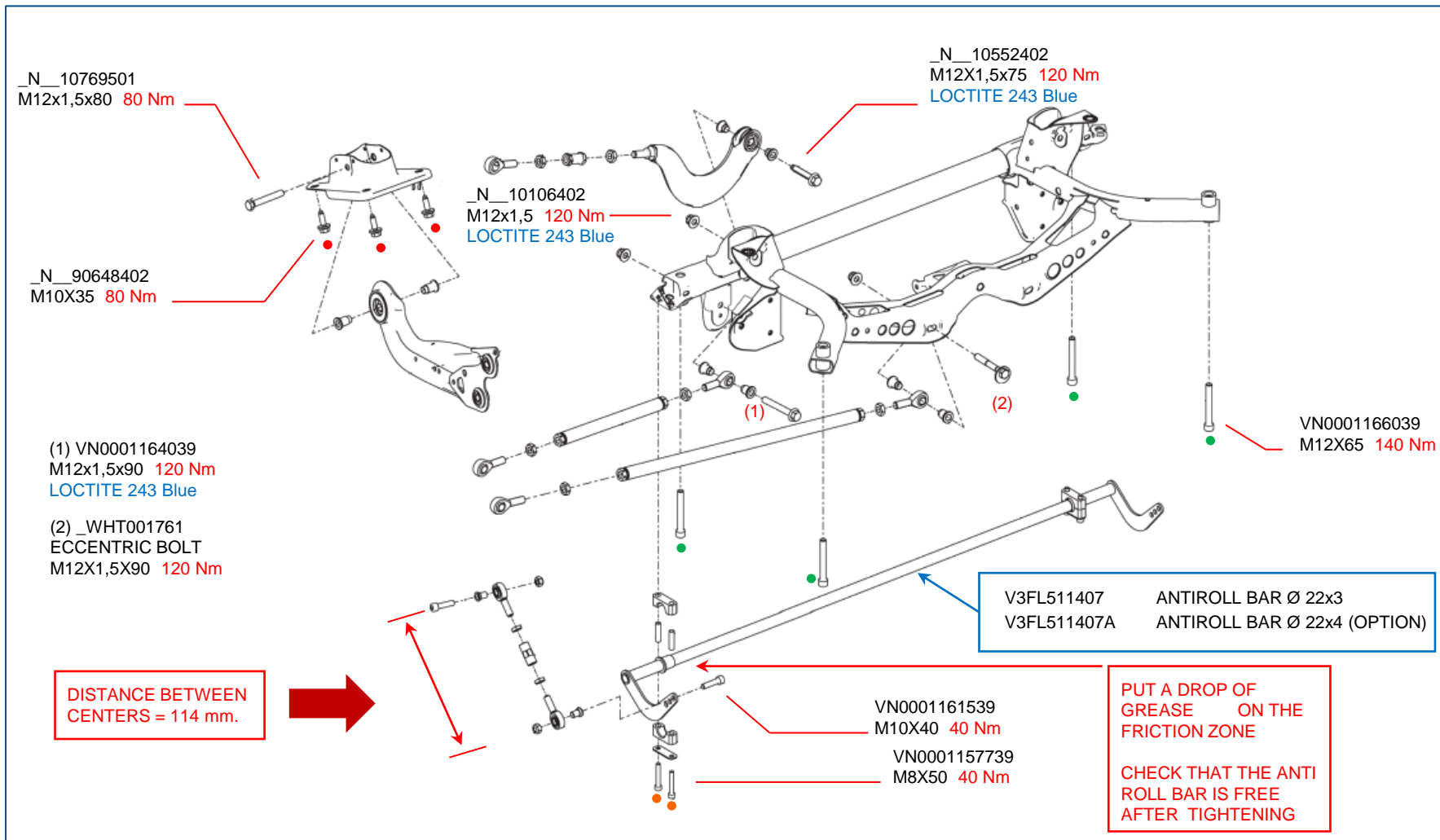

TIGHTENING TORQUE PEDAL BOX

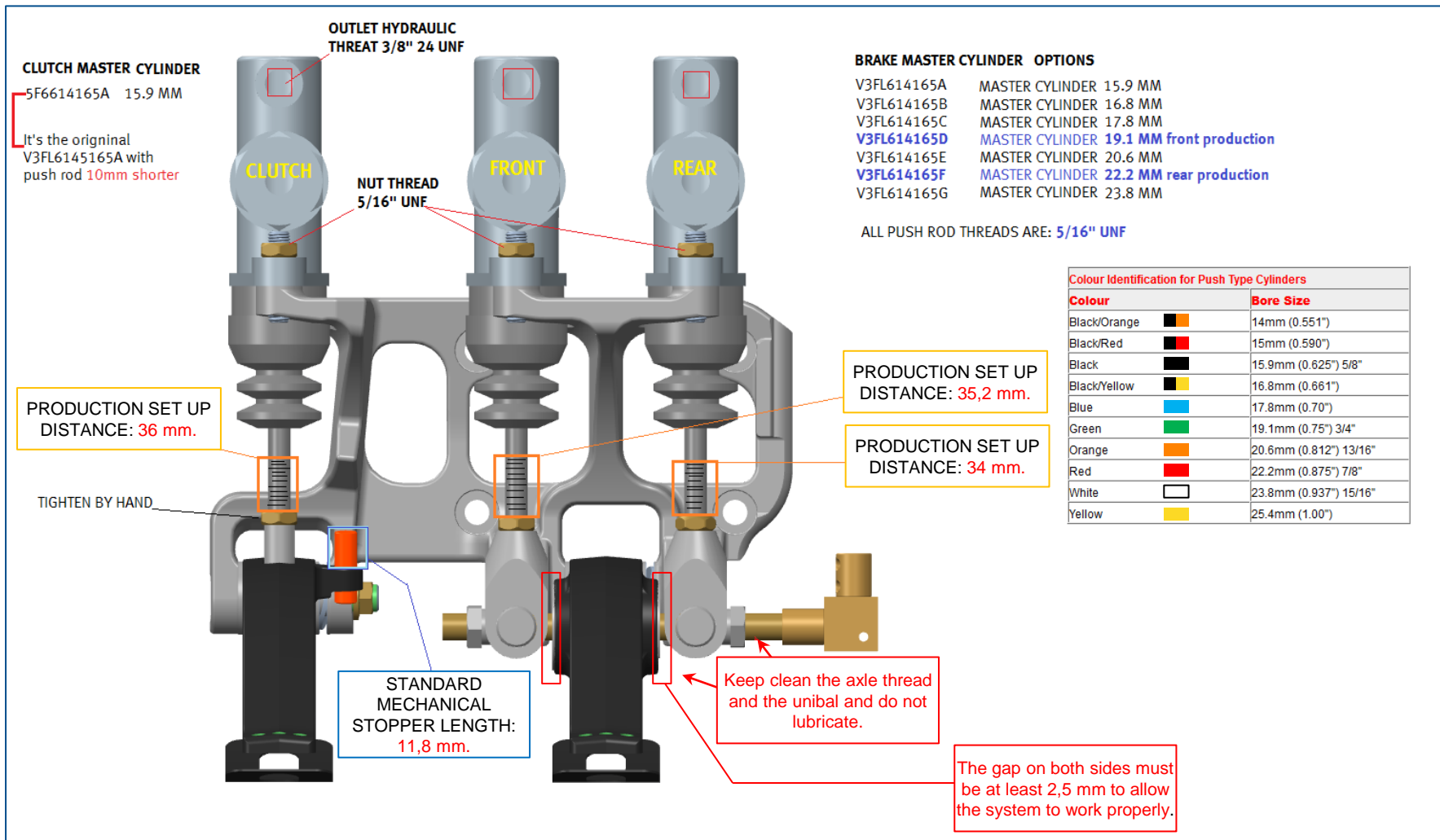

TIGHTENING TORQUE FRONT & REAR END

N 91196402
HEX. HEAD BOLT
M10x35 **60 Nm**

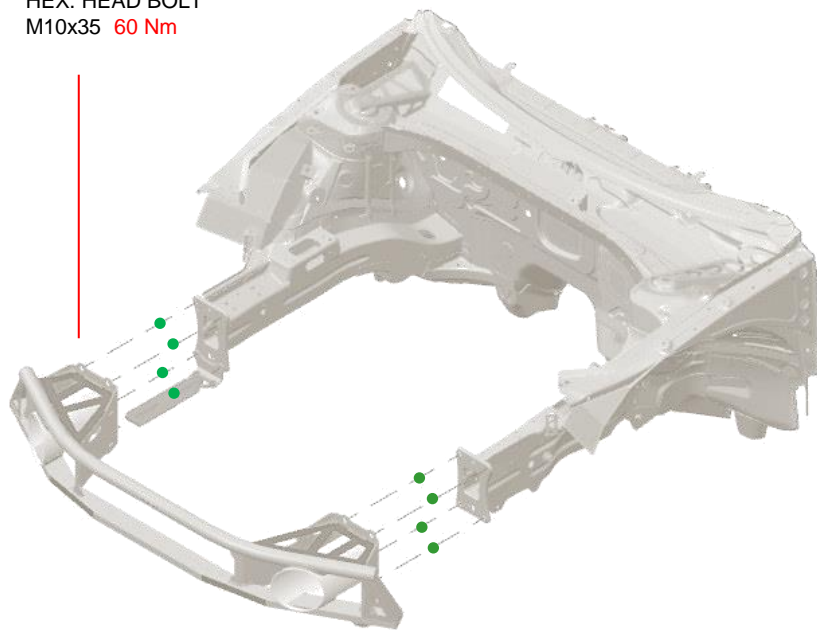

N 0195307
HEX. HEAD BOLT
M8x25 **25 Nm**

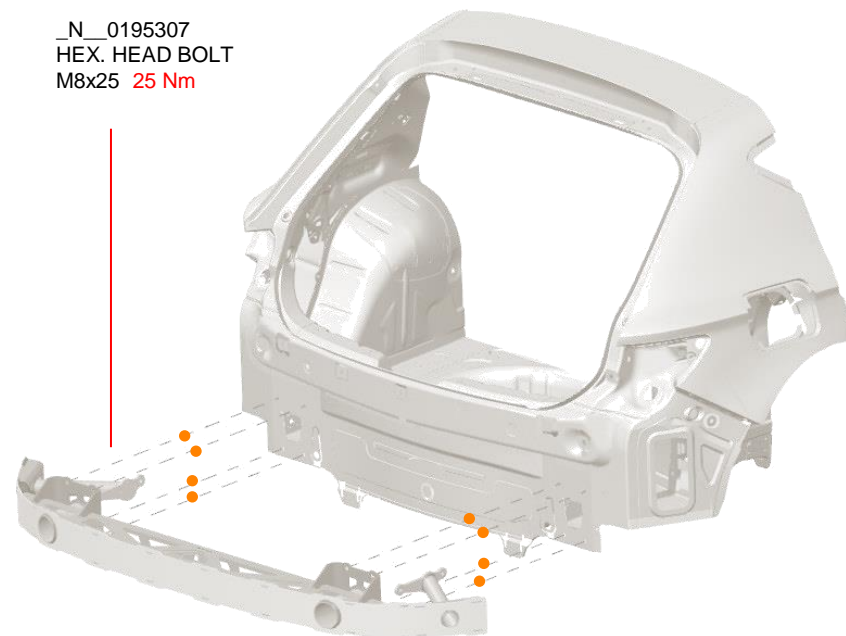

TIGHTENING TORQUE BUCKET SEAT

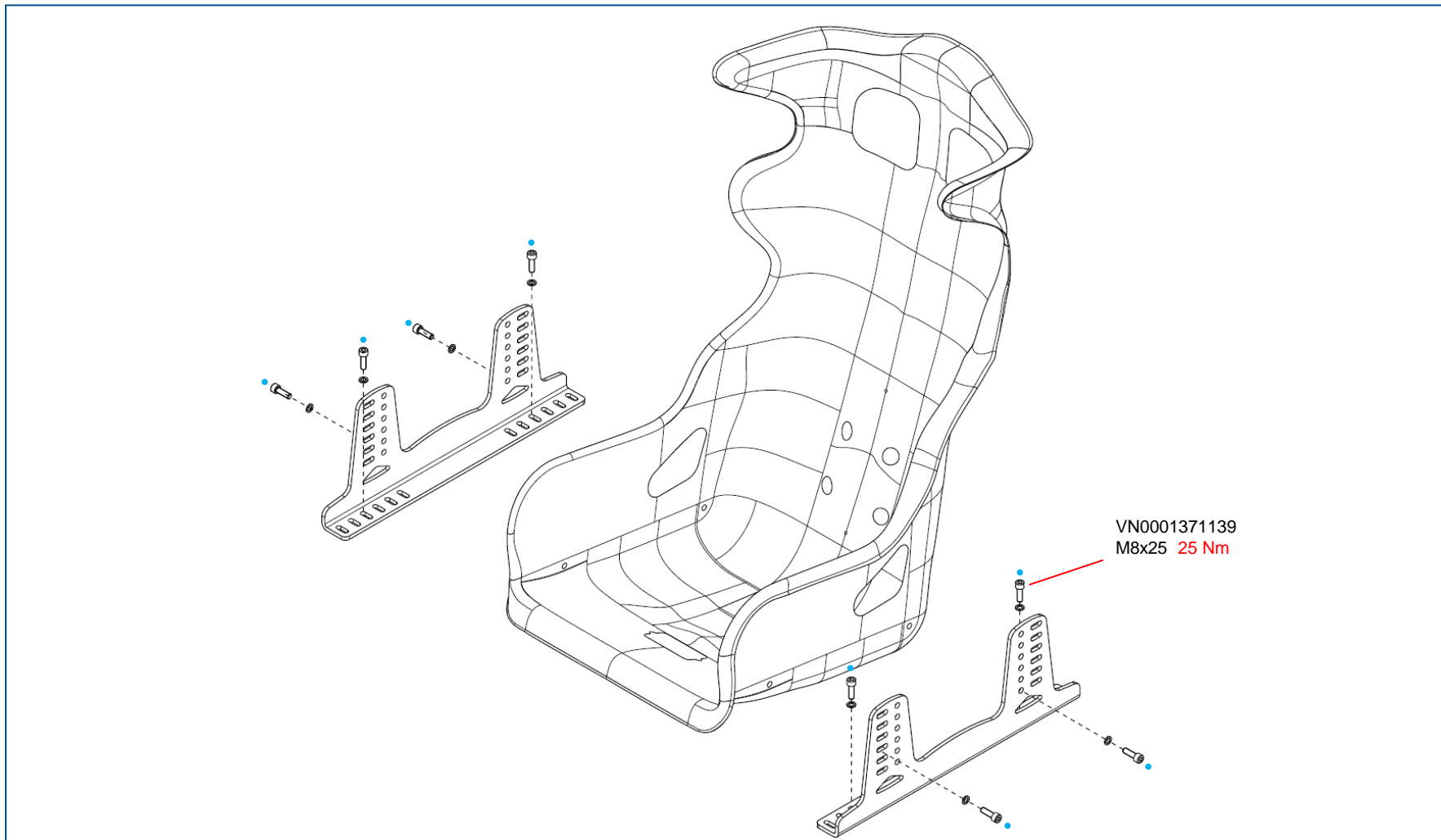

TIGHTENING TORQUE BALLAST FIXATION

In the event that any car needs to add some extra weight, there are different shapes and sizes to be combined between them. They are detailed here below:



5F6861721
1 KG BALLAST



5F6861721A
3 KG BALLAST

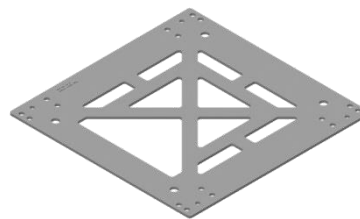

5F6861721H – 5 KG
5F6861721J – 10 KG
5F6861721K– 20 KG

5, 10 & 20 KG SQUARED BALLAST



5F6861721L – 5 KG
5F6861721M – 10 KG
5F6861721N– 20 KG

5, 10 & 20 KG ADVANCED BALLAST

The “Advanced Ballast” solution allows to put the weight in position closer to the front of the car. In order to make a safe assembly, M8 bolts with a minimum of 12 mm thread depth is recommended.

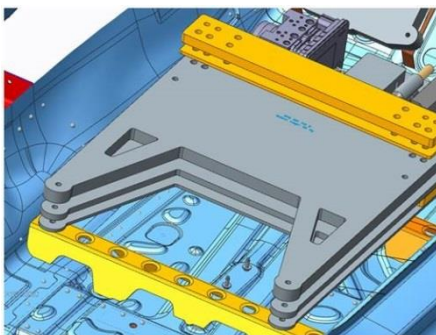

The picture shows how to fix the “Advanced ballast” to the car.

TIGHTENING TORQUE

DSG GEARBOX

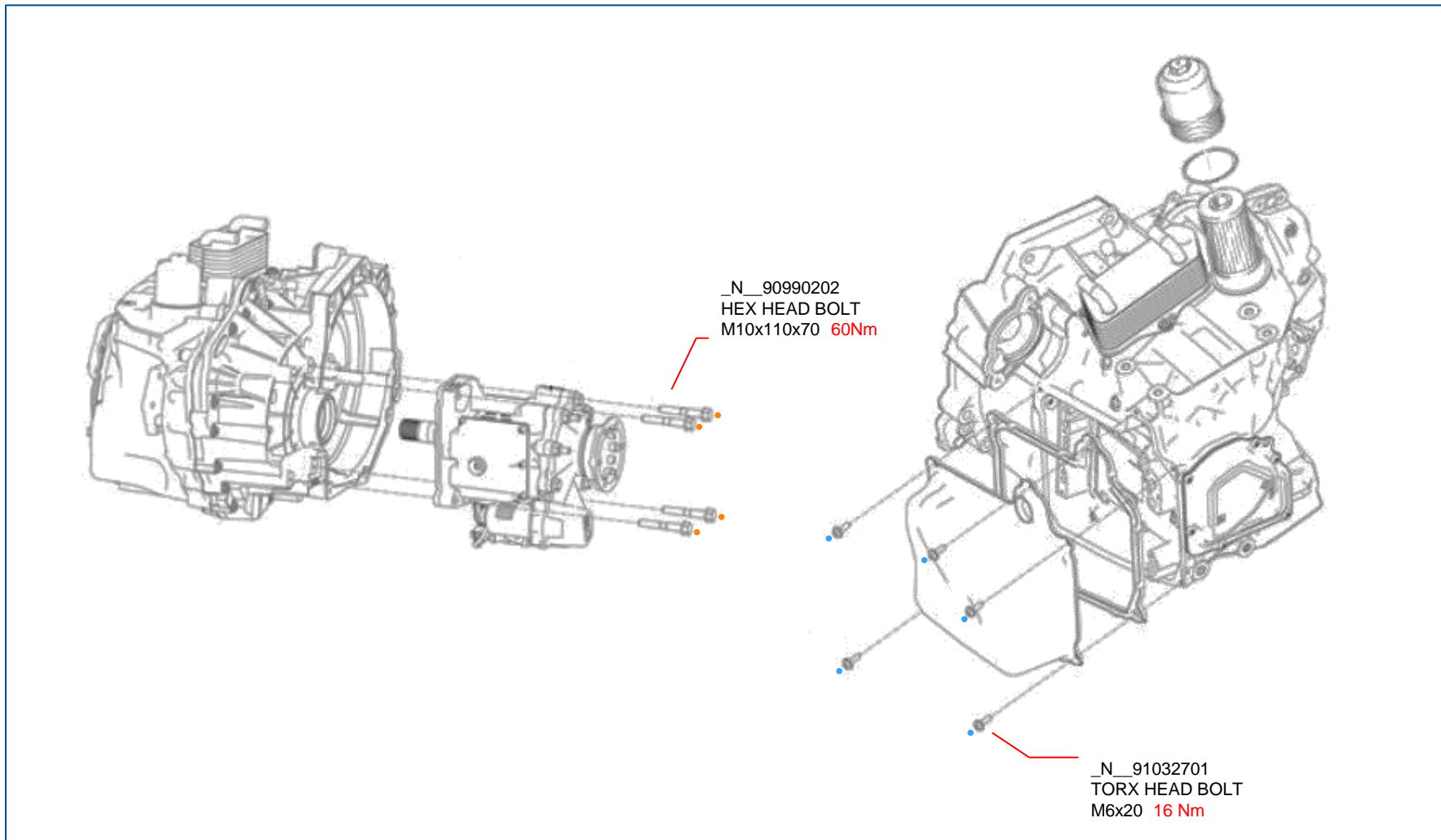

TIGHTENING TORQUE

DSG GEARBOX

